

STATE OF CALIFORNIA WELL COMPLETION REPORT

Refer to Instruction Pamphlet

Owner's Well No. _____

No. **758408**

Date Work Began 10-22-01, Ended 10-22-01

Local Permit Agency San Luis Obispo County Health Dept

Permit No. 2001-339 Permit Date 10-01

DWR USE ONLY — DO NOT FILL IN

STATE WELL NO./STATION NO. _____

LATITUDE _____ LONGITUDE _____

APN/TRS/OTHER _____

GEOLOGIC LOG

ORIENTATION (≅)			DRILLING METHOD	FLUID	DESCRIPTION
<input checked="" type="checkbox"/> VERTICAL <input type="checkbox"/> HORIZONTAL <input type="checkbox"/> ANGLE _____ (SPECIFY)					
DEPTH FROM SURFACE					
Fl	to	Fl.			
0	3		<u>Rotary</u>	<u>Bentonite</u>	<u>Top soil</u>
3	15				<u>Shale gravel</u>
15	20				<u>White clay</u>
20	22				<u>Brown clay</u>
22	90				<u>Shale gravel</u>
90	95				<u>Lite blue clay</u>
95	110				<u>Shale gravel</u>
110	120				<u>Lite blue clay</u>
120	135				<u>Shale gravel</u>
135	140				<u>Blue clay</u>
140	155				<u>Blue shale gravel</u>
155	160				<u>Blue clay</u>
160	175				<u>Shale gravel</u>
175	185				<u>Blue clay</u>
185	190				<u>Blue shale gravel</u>
190	195				<u>Blue clay</u>
195	300				<u>Blue shale gravel</u>

WELL OWNER

Name Roger & Anna Franklin

Mailing Address 179 Niblick

CITY Paso Robles, Calif. 93446 STATE _____ ZIP _____

WELL LOCATION

Address Neal Springs Road Lot #4

City Paso Robles

County San Luis Obispo

APN Book 033 Page 321 Parcel 016

Township 278 Range 12E Section 13

Latitude 35 34 17 NORTH Longitude 120 38 24 WEST

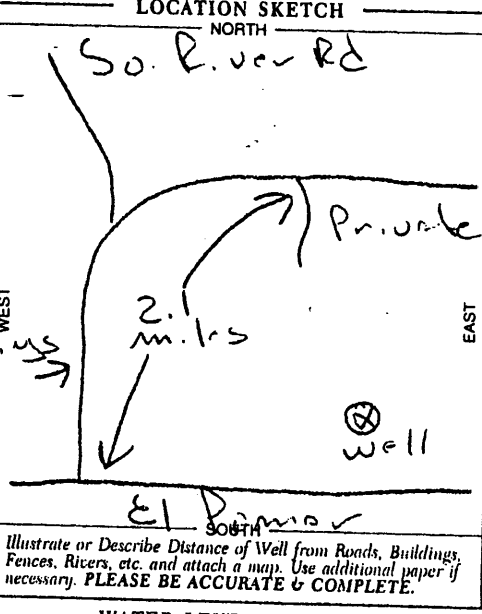

ACTIVITY (≅)

NEW WELL

MODIFICATION/REPAIR

Deepen

Other (Specify) _____

DESTROY (Describe Procedures and Materials Under "GEOLOGIC LOG")

PLANNED USES (≅)

WATER SUPPLY

Domestic Public

Irrigation Industrial

MONITORING _____

TEST WELL _____

CATHODIC PROTECTION _____

HEAT EXCHANGE _____

DIRECT PUSH _____

INJECTION _____

VAPOR EXTRACTION _____

SPARGING _____

REMEDATION _____

OTHER (SPECIFY) _____

NOTE:

ANY PERSON REMOVING THE CAP FROM THIS WELL OTHER THAN MILLER DRILLING CO OR AUTHORIZED CONTRACTOR APPROVED BY US WILL VOID ALL STRUCTURAL WARRANTIES.

Illustrate or Describe Distance of Well from Roads, Buildings, Fences, Rivers, etc. and attach a map. Use additional paper if necessary. PLEASE BE ACCURATE & COMPLETE.

WATER LEVEL & YIELD OF COMPLETED WELL

DEPTH TO FIRST WATER 195 (Fl.) BELOW SURFACE

DEPTH OF STATIC WATER LEVEL 176 (Fl.) & DATE MEASURED 10-22-01

ESTIMATED YIELD 80@300 (GPM) & TEST TYPE Blow test

TEST LENGTH _____ (Hrs.) TOTAL DRAWDOWN _____ (Fl.)

* May not be representative of a well's long-term yield.

TOTAL DEPTH OF BORING 300 (Feet)

TOTAL DEPTH OF COMPLETED WELL 300 (Feet)

DEPTH FROM SURFACE	BORE-HOLE DIA. (Inches)	CASING (S)							
		TYPE (≅)				MATERIAL / GRADE	INTERNAL DIAMETER (Inches)	GAUGE OR WALL THICKNESS	SLOT SIZE IF ANY (Inches)
		BLANK	SCREEN	CON-DUCTOR	FILL PIPE				
0	200	9 7/8	X			F480 PVC	5	.265	
200	300	9 7/8	X			F480 PVC	5	.265	.060

DEPTH FROM SURFACE	ANNULAR MATERIAL			
	TYPE			
	CE-MENT (≅)	BEN-TONITE (≅)	FILL (≅)	FILTER PACK (TYPE/SIZE)
0	50	X		
50	300			Lapis Mix

ATTACHMENTS (≅)

Geologic Log

Well Construction Diagram

Geophysical Log(s)

Soil/Water Chemical Analyses

Other _____

ATTACH ADDITIONAL INFORMATION, IF IT EXISTS.

CERTIFICATION STATEMENT

I, the undersigned, certify that this report is complete and accurate to the best of my knowledge and belief.

NAME Miller Drilling Company
(PERSON, FIRM, OR CORPORATION) (TYPED OR PRINTED)

ADDRESS 301 North Main Street Templeton Calif. 93465 AA
CITY STATE ZIP

Signed [Signature]
WELL DRILLER AUTHORIZED REPRESENTATIVE

DATE SIGNED _____ C-57 LICENSE NUMBER _____



Roger Franklin
179 Niblick Road
Paso Robles, CA 93446

Log Number: 02-C687
Order: J0220
Project: Franklin
Received: 01/15/02

REPORT OF ANALYTICAL RESULTS

SAMPLE DESCRIPTION	SAMPLED BY	SAMPLED		MATRIX	
		DATE @ TIME			
Well # 3	Rod Hewett	01/15/02@12:25		Drinking Water	
ANALYTE	RESULT	* R. L.	UNITS	METHOD	ANALYZED
Total Alkalinity as CaCO3	230	2	mg/L	EPA 310.1	01/25/02
Chloride	40	1	mg/L	EPA 300.0	01/15/02
Total Cyanide	Not Detected	0.01	mg/L	EPA 335.2	01/25/02
Color	Not Detected	1	units	EPA 110.2	01/15/02
Electrical Conductance	620	1	umhos/cm	EPA 120.1	01/15/02
Fluoride	Not Detected	1	mg/L	EPA 300.0	01/15/02
MBAS (Anionic Surfactants)	Not Detected	0.05	mg/L	EPA 425.1	01/16/02
Nitrate as N	Not Detected	0.1	mg/L	EPA 300.0	01/15/02
Nitrate as NO3	Not Detected	0.4	mg/L	EPA 300.0	01/15/02
Nitrite as N	Not Detected	0.1	mg/L	EPA 300.0	01/15/02
Odor	Not Detected	1	TON	EPA 140.1	01/15/02
pH	7.4	0.1	units	EPA 150.1	01/15/02
Sulfate	76	0.5	mg/L	EPA 300.0	01/15/02
Total Dissolved Solids	410	10	mg/L	EPA 160.1	01/20/02
Turbidity	0.5	0.1	NTU	EPA 180.1	01/15/02
Silver	Not Detected	0.01	mg/L	EPA 200.7	01/29/02
Aluminum	Not Detected	0.05	mg/L	EPA 200.7	01/29/02
Arsenic	0.014	0.002	mg/L	EPA 200.9	01/24/02
Barium	Not Detected	0.1	mg/L	EPA 200.7	01/29/02
Beryllium	Not Detected	0.001	mg/L	EPA 200.7	01/29/02
Calcium	68	0.03	mg/L	EPA 200.7	01/29/02
Hardness	320	1	mg/L CaCO3	EPA 200.7	01/29/02
Cadmium	Not Detected	0.001	mg/L	EPA 200.9	01/29/02
Chromium	Not Detected	0.01	mg/L	EPA 200.7	01/29/02
Copper	Not Detected	0.05	mg/L	EPA 200.7	01/29/02
Iron	Not Detected	0.1	mg/L	EPA 200.7	01/29/02
Mercury	Not Detected	0.001	mg/L	EPA 245.1	01/29/02
Potassium	1.0	0.1	mg/L	EPA 200.7	01/29/02
Magnesium	37	0.03	mg/L	EPA 200.7	01/29/02
Manganese	Not Detected	0.03	mg/L	EPA 200.7	01/29/02



CREEK ENVIRONMENTAL LABORATORIES, INC.

141 SUBURBAN ROAD, SUITE C-5 • SAN LUIS OBISPO, CA 93401 • (805) 545-9838 • FAX (805) 545-0107

Roger Franklin
179 Niblick Road
Paso Robles, CA 93446

Log Number: 02-C687
Order: J0220
Project: Franklin
Received: 01/15/02

REPORT OF ANALYTICAL RESULTS

SAMPLE DESCRIPTION	SAMPLED BY	SAMPLED		MATRIX	
		DATE @ TIME			
Well # 3	Rod Hewett	01/15/02@12:25		Drinking Water	
ANALYTE	RESULT	* R.L.	UNITS	METHOD	ANALYZED
Sodium	22	0.05	mg/L	EPA 200.7	01/29/02
Nickel	Not Detected	0.01	mg/L	EPA 200.7	01/29/02
Lead	Not Detected	0.005	mg/L	EPA 200.9	01/28/02
Antimony	Not Detected	0.006	mg/L	EPA 200.9	01/29/02
Selenium	Not Detected	0.005	mg/L	EPA 200.9	01/23/02
Thallium	Not Detected	0.001	mg/L	EPA 200.9	01/30/02
Zinc	Not Detected	0.05	mg/L	EPA 200.7	01/29/02

* R.L. - Reporting Limit. 'RESULTS' reported as "Not Detected" means not detected above R.L.

CREEK ENVIRONMENTAL LABORATORIES

Lab Director, Orval Osborne



DRINKING WATER EVALUATION

"MCL" is Maximum Contaminant Level, the highest acceptable concentration of analyte. Compare these MCL's to your results. **Acceptable RESULTS are less than the MCL's for each analyte.** The MCL's are determined by California Department of Health Services. They are listed in the Code of Regulations, Title 22, Sections 64435 & 64473. "ANALYTE" is the chemical constituent being measured.

"UNITS" are in mg/L (ppm). mg/L = milligrams per liter. ppm = parts-per-million. To convert mg/L to ug/L (ppb): 1 mg/L = 1,000 ug/L. 1 ug/L = 0.001 mg/L.

PRIMARY DRINKING WATER STANDARDS

Primary standards analytes have potential toxic effects when above the MCL.

<u>ANALYTE</u>	<u>MCL</u>	<u>UNITS</u>	<u>ANALYTE</u>	<u>MCL</u>	<u>UNITS</u>
Aluminum	1	mg/L	Nickel	0.1	mg/L
Antimony	0.006	mg/L	Selenium	0.05	mg/L
Arsenic	0.05	mg/L	Silver	0.05	mg/L
Barium	1	mg/L	Thallium	0.002	mg/L
Beryllium	0.004	mg/L	Zinc	5	mg/L
Cadmium	0.005	mg/L	Cyanide	0.2	mg/L
Chromium	0.05	mg/L	Fluoride	2	mg/L
Lead	0.05	mg/L	Nitrate as NO3	45	mg/L
Mercury	0.002	mg/L	Nitrite	1	mg/L

SECONDARY DRINKING WATER STANDARDS

These aesthetic standards analytes may contribute to undesirable characteristics when over MCL's, but are not threats to human health.

<u>ANALYTE</u>	<u>MCL</u>	<u>UNITS</u>	<u>ANALYTE</u>	<u>MCL</u>	<u>UNITS</u>
Copper	1	mg/L	Color	15	Units
Iron	0.3	mg/L	Odor	3	Units
Manganese	0.05	mg/L	Turbidity	5	Units
MBAS	0.5	mg/L			

	<u>MCL: RECOMMENDED</u>	<u>UPPER</u>	<u>SHORT TERM</u>	<u>UNITS</u>
Chloride	250	500	600	mg/L
Sulfate	250	500	600	mg/L
Electrical Conductance	900	1600	2200	umhos/cm
Total Dissolved Solids	500	1000	1500	mg/L

Analytes not listed above have no MCL established, so any level is acceptable. NOTE: Organic chemicals, solvents, pesticides, herbicides, radioactivity, asbestos or bacteria are not included in above tests.